

Costa Diadema

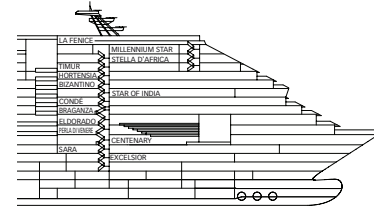

Grt: 132.500 t
 Length: 306 m
 Width: 37,2 m
 Cruising speed: 20 knots
 Max speed: 22,5 knots

- single cabins
- H cabins for disabled guests
- C interconnecting cabins
- E lift
- * double sofa bed
- 1 upper berth
- single sofa bed
- ▲ 2 low beds that cannot be converted into a double
- ▲ cannot be converted into a double

Nota bene: Double bed is available in all cabin grades.

- Inside cabin**
- Classic
 - Premium
 - Samsara

Excelsior, Sara, Braganza, Condé, Star of India, Bizantino

Sara, Braganza, Condé, Star of India, Bizantino, Hortensia

Timur, Stella d'Africa

- Outside cabins ocean view**
- Classic
 - Premium

Excelsior, Sara, Braganza, Condé, Bizantino, Hortensia

Excelsior, Sara

- Cabin with ocean balcony**
- Classic*
 - Premium
 - Samsara

Sara Braganza, Condé

Timur, Stella d'Africa

*Cabins with loggia balcony (balcony door can be closed by the crew in case of bad weather)

- Suites**
- Mini Suite with Ocean View Balcony
 - Suite with Ocean View Balcony
 - Grand Suite with Ocean View Balcony
 - Samsara Suite with ocean view verand and jacuzzi.
 - Samsara Grand Suite with ocean view veranda, jacuzzi and balcony.

Condé, Star of India, Braganza

Condé, Bizantino

Condé

Timur, Stella d'Africa

Timur

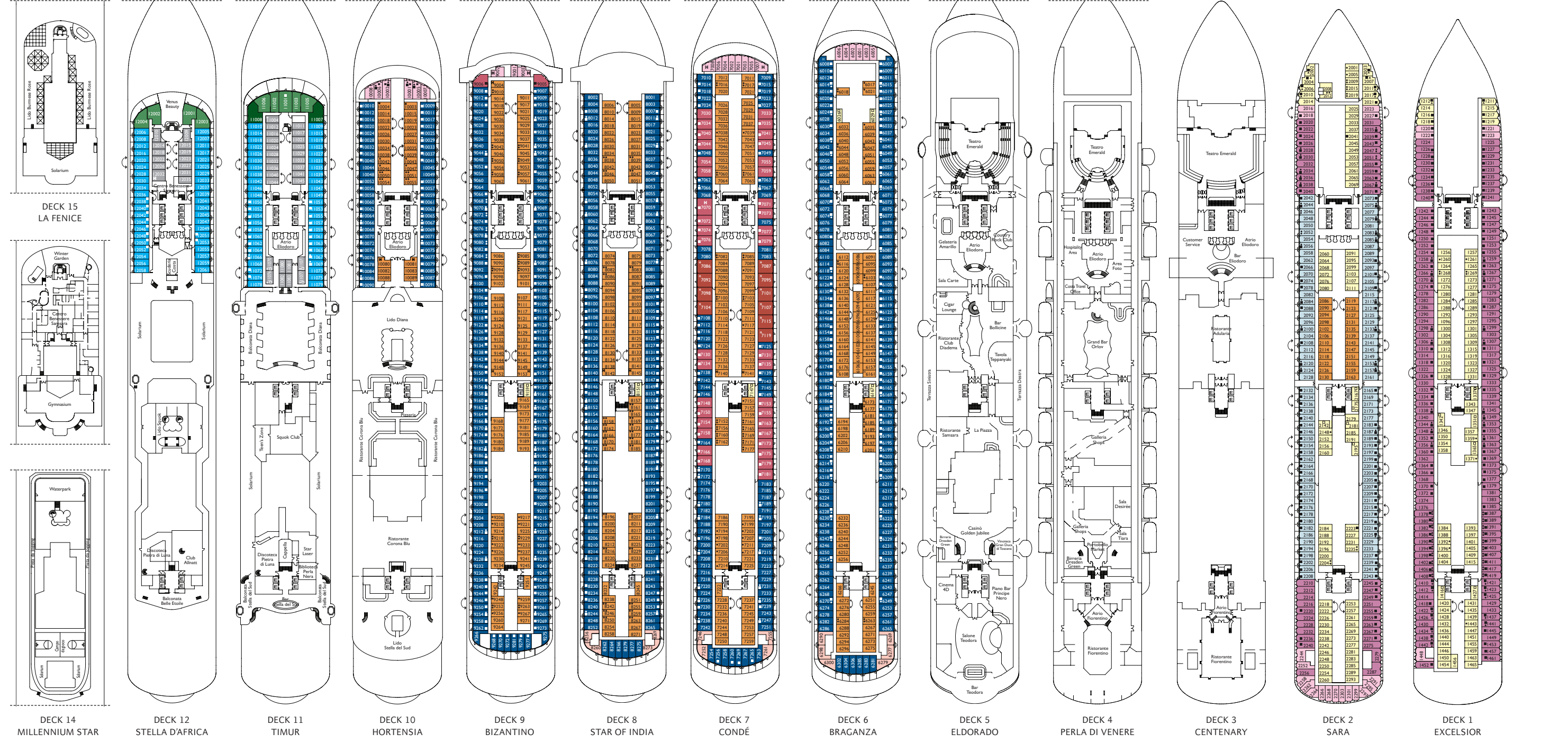

Costa Diadema | Cabins

Cabin Features

New to families who can now count on even more comfortable cabins: the Premium outside cabins with sea view and 5 beds and double bathroom.

If you want to feel even closer to the sea, you can choose the newly offered cabins with balconies on deck 2.

Cove Balcony

Specially designed with the balcony set directly into the hull, creating a private oasis which guarantees maximum privacy as well as a 'front-row seat'.



Private balcony: 3 m long x 2 m wide

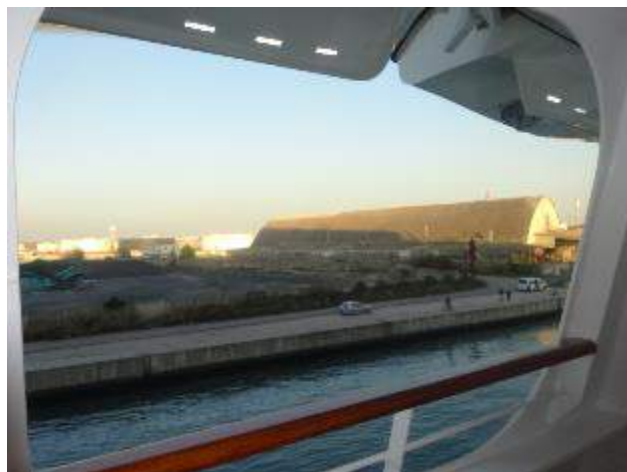



In the event of bad weather, the door will be closed by the crew (Guests will still have a normal porthole window with light).





Objections

The Cove Balconies don't guarantee me the classic views the other Balconies have. .
Cabins with sea-facing covered balcony on deck 2, thanks to a special design with balcony set directly into the hull, offer a private oasis that guarantees maximum privacy and allows you to enjoy the sea view. For the first time, you can be in direct contact with the sea and enjoy the scent of the sea breeze.

Premium outside cabins with double bath

The cruise becomes family size.

- All EP cabins (173 in all) are located on decks 1 and 2 and have 2 bathrooms
- There are 20 five-person EP cabins on deck 1 with 2 bathrooms.

The cabin itself is appr. 17 sq. m. It consists of a double bed by the window on the central wall opposite the entrance. 3° bed is on a wall next to the double bed. Bed 4 is a sofa bed facing the double and bed 5 is located above the sofa bed.

The cabin also has 2 small bathrooms situated in the short entrance hall The first bathroom consists of WC, wash basin and shower, and the second (accessible from the second door) of was basin and small bath tub. The cabin is comfortable despite being occupied by five people.

To summarise: cabin of appr. 20 sq.m. total with 2 bathrooms consists of 2 single beds or double bed and 2 pullman beds + 1 sofa bed

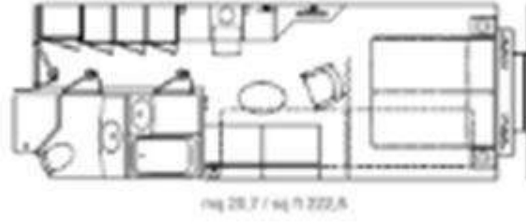
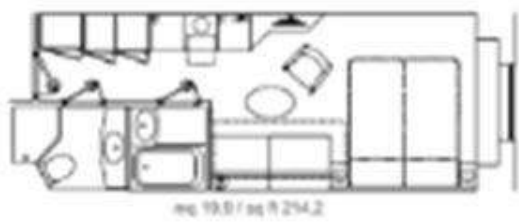

First bathroom



Second bathroom

Costa Diadema | Bars

Bars

The Italian tradition of the aperitivo at sunset or the leisurely stroll with an ice cream are the themes of the bar on deck 5.

Here's where you'll find delicacies to sample and enjoy:

Gelateria Amarillo

In the Gelateria you can try delicious new flavours - something for everyone.

It'll be hard to resist the multi-coloured candy waterfall, and even harder with the great chocolate fountain which dominates the centre of the room.

- An environment to feast your eyes on, like something out of a fairy tale, situated at the fore end of deck 5
- 18 different flavours of ice cream from Agrimontana, leaders in hand crafted ice cream
- 6 varieties of crepes, 12 varieties of hot chocolate, desserts and Italian cakes, chocolates and pralines
- 45 total places over 135 sq.m.



Vinoteca Gran Duca di Toscana

The Vinoteca is the ideal place to meet up before dinner in the best company. The most refined palates can sample the excellence of Italian and French products, served with cheese and snacks from around the world.

- Unique and indescribable experiences for the senses
- Selected bottled wines or served in modern dispensers at the perfect temperature.
- 80 different top quality wines, chosen in collaboration with the AIS (Italian Sommeliers Association)
- 36 places + 12 places outside

Did you know?

Starting from January 2015, something special for on board Guests: - exclusive dishes and special wines selected by our Executive Chef can be enjoyed in the Vinoteca Grad Duca di Toscana

Booking necessary.



Prosecceria Bar Bollicine

On Costa Diadema, everything is sparkling and especially in the Bar Bollicine
The atmosphere is bright and sophisticated, where the reflection of the glass decoration goes with the bubbles of the finest beverages.

- The ideal place to celebrate your holiday or special occasion.
- Enjoy the cocktail of the day sitting in the outside area looking directly out to sea.
- Aperitivi and a wide variety of Superior DOCG Proseccos 99 seats over an inside space of 400 sq.m. and outside 27 sq.m.



Bar Teodora

Aft deck 5 is where you'll find the Bar Teodora, with tables and armchairs arranged around the large dance floor for the evenings of Latin American music.

Here you can relax over a cocktail in a perfect setting between one song and the next.

- New tropical cocktails created for the Teodora outside bar while you enjoy the sea view at sundown: Tropical, Tropical Colada, Margarita Passion Caipirinhas.

- Nibbles, snacks such as cold pasta salad and rice, sandwiches, focaccia and olives served with your aperitivo
- The Teodora lounge on the large open area on aft deck 5 is where you watch the wash of the ship to the sound of music



Birreria Dresden Green

An authentic German Pub on the open sea is just one of the extraordinary experiences awaiting you on board Costa Diadema.

- Wooden furnishings, exposed beams, and real ale from barrels and copper kegs
- The ideal setting to party and spend time in the company of friends.
- You can also enjoy a great pint of your favourite bitter or lager on deck 5 outside looking out to sea



Oyster Aperitif

Every evening the appointment with the Ferrari sparkling wines and the oysters taste.
A “must” with no black tie need!

